

C-212-281

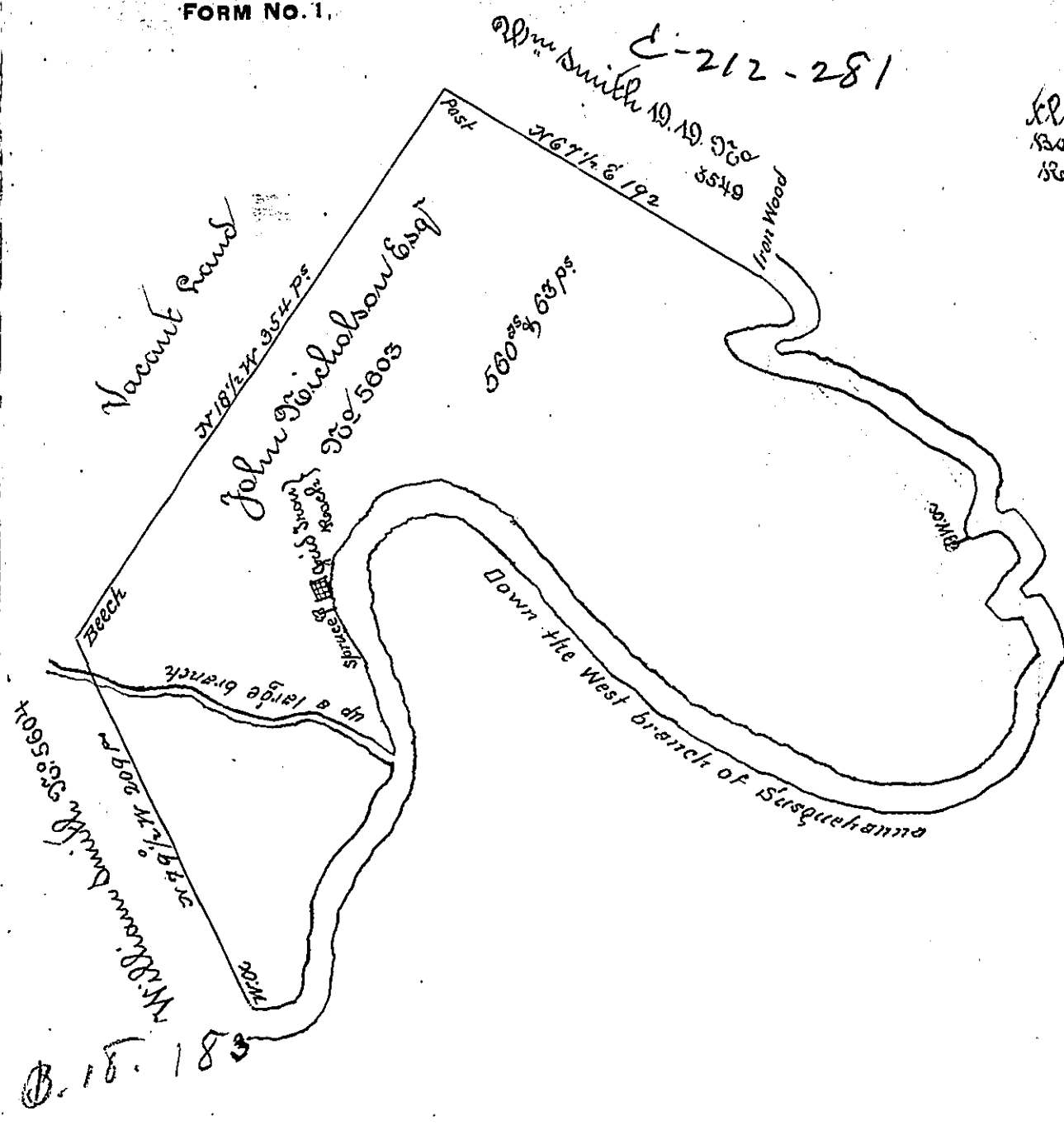

The Courses to Iron Wood below to the White Oak above along the River -

S 82 E	24 ^h	S 8 E	25
South	6	S 42 E	8
S 19 W	26	S 15 E	40
S 68 E	8	S 20 (obl)	
S 55 E	38	S 80 E (obl)	
N 70 E	7	S 19 E (obl)	
N 65 E	94	S 25 W (obl)	
S 45 E	34 W.O.	S 35 W (obl)	W.
S 58 W	11		
N 68 E	14	above	
N 19 E	17		
N 85 E	14		
S 9 E	30		
S 87 E	15		
N 36 E	16		
S 72 E	16		
S 12 E	24		
S 49 E	25		
S 27 E	6		
S 3 E	7		
S 11 W	21		
S 33 W	14		
S 43 W	21		
S 52 W	15		
S 62 W	14		
S 65 W	75		
S 68 W	20		
S 77 W	50		
S 82 W	65		
S 54 W	42		
S 20 W	31		
S 17 E	42		
S 56 E	22		
S 85 E	53		
S 84 E	26		
S 31 E	12		

Situate on the North side of the West Branch of Susquehanna about five miles below the Cherry Tree Survey containing five hundred & sixty acres & sixty three perches & the usual allowance of six per cent for roads surveyed the seventeenth day of June 1794 in pursuance of a Warrant granted to John Nicholson Esq No: 5603 dated the second day of April 1794 to Daniel Brodhead Esq: D.C:

James Hunter D.D.
" — =

IN TESTIMONY that the above is a copy of the original remaining on file in the Department of Internal Affairs of Pennsylvania, made conformably to an Act of Assembly approved the 16th day of February, 1833, I have hereunto set my Hand and caused the Seal of said Department to be affixed at Harrisburg, this second _____ day of February _____ 1897

James W. Latta
Secretary of Internal Affairs